

0.5"–2.0" SIZES ONLY

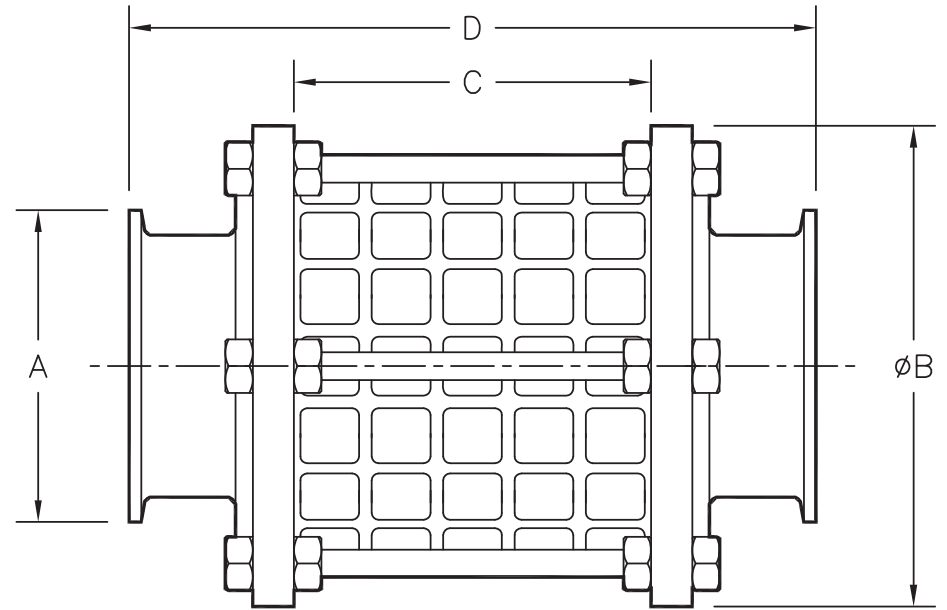

2.5"–6.0" SIZES ONLY

A	B		C		D		MAX. PRESSURE*		MAX. TEMP.**	
	mm	in.	mm	in.	mm	in.	Bar	PSIG	°C	°F
0.5"	27	1.1	80	3.2	135	5.3	14	205	150	300
0.75"	34	1.3	80	3.2	135	5.3				
1.0"	42	1.7	80	3.2	152	6.0	16	230		
1.5"	60	2.4	80	3.2	152	6.0	13	195		
2.0"	109	4.3	80	3.2	152	6.0	12	175		
2.5"	127	5.0	100	3.9	176	6.9	9	130		
3.0"	142	5.6	100	3.9	200	7.9	6	95		
4.0"	162	6.4	100	3.9	204	8.0				
6.0"	226	8.9	162	6.4	305	12.0	7	100	102	215

* PRESSURE BASED ON PYREX GLASS

** TEMP. BASED ON EPDM ELASTOMER

THIS DRAWING AND ALL IDEAS INCORPORATED IN ITS DESIGN IS THE EXCLUSIVE PROPERTY OF FLOWTECH, INC. ITS ACCEPTANCE CONSTITUTES AN AGREEMENT THAT IT SHALL BE TREATED AS A CONFIDENTIAL DOCUMENT USED FOR NO OTHER PURPOSE THAN TO AID IN ITS CONSTRUCTION. THAT IT IS TO BE RETURNED UPON REQUEST, AND THAT IT IS NOT TO BE DISCLOSED OR COPIED EXCEPT AS AUTHORIZED IN WRITING BY FLOWTECH, INC.

UNIBLOC-PUMP INC
FLOWTECH DIV. USA

MATERIAL	SS 304 OR 316
FINISH(UNLESS NOTED ON DWG.)	
WEIGHT	

BY	DATE
DRAWN	
CHECKED	
APP'D	
SCALE	
ALL DIMENSIONS IN INCHES	

DWG. TITLE	
#53 IN-LINE SIGHTGLASS	
SIZE	DWG. NO.
0.5"–6.0"	
RELEASE DATE AUG. 26, 2009 SHEET 1 OF 1	