

SEE DWG. G806 FOR  
SHAFT SEAL PARTS

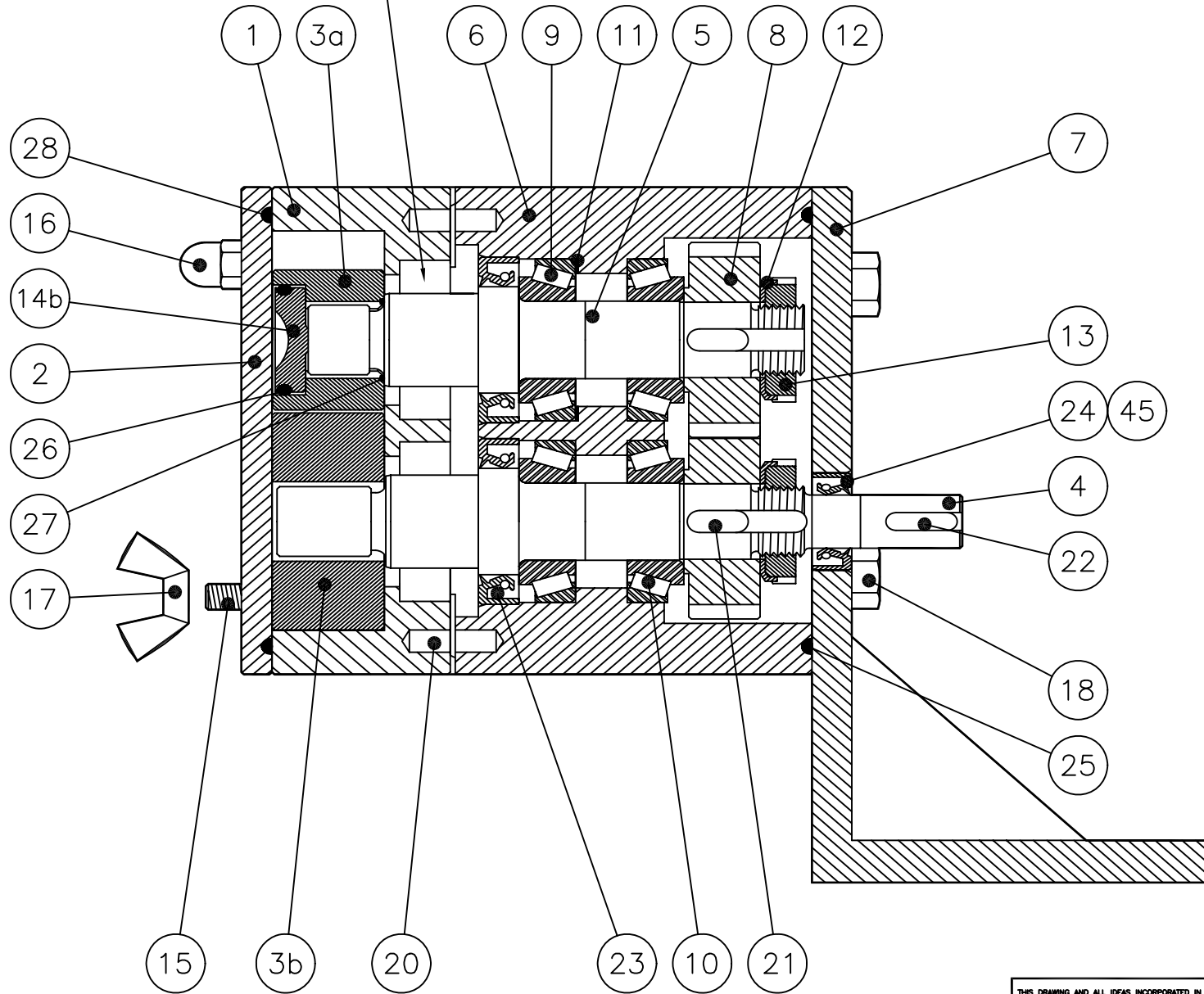

NO.	PCS.	DESCRIPTION
45	1	BLIND REAR OIL SEAL
28	1	ROTOR COVER O-RING
27	2	ROTOR-SHAFT O-RING
26	2	ROTOR BOLT O-RING
25	1	O-RING
24	1	REAR OIL SEAL
23	2	FRONT OIL SEAL
22	1	DRIVE SHAFT KEY
21	2	KEY
20	2	DOWEL PIN
18	4	COVER BOLT
17	4	HAND NUT
16	4	DOME NUT
15	4	HOUSING STUD
14b	2	ROTOR BOLT (SLOTTED)
13	2	SLOTTED NUT
12	2	TAB WASHER
11	2	SHIM RING
10	2	REAR BEARING
9	2	FRONT BEARING
8	2	GEAR
7	1	BEARING COVER
6	1	BEARING HOUSING
5	1	LAY SHAFT
4	1	DRIVE SHAFT
3b	2	PLASTIC ROTOR
3a	2	METAL ROTOR
2	1	ROTOR COVER
1	1	ROTOR HOUSING
NO.	PCS.	DESCRIPTION

THIS DRAWING AND ALL IDEAS INCORPORATED IN ITS DESIGN IS THE EXCLUSIVE PROPERTY OF FLOWTECH, INC. ITS ACCEPTANCE CONSTITUTES AN AGREEMENT THAT IT SHALL BE TREATED AS A CONFIDENTIAL DOCUMENT USED FOR NO OTHER PURPOSE THAN TO AID IN ITS CONSTRUCTION, THAT IT IS TO BE RETURNED UPON REQUEST, AND THAT IT IS NOT TO BE DISCLOSED OR COPIED EXCEPT AS AUTHORIZED IN WRITING BY FLOWTECH, INC.

**UNIBLOC®-PUMP, INC.**  
FLOWTECH DIV. USA

DWG. TITLE  
**UNIBLOC-PD PUMP  
PARTS LIST**

SIZE  
**200,250,275**

DWG. NO.  
**G805**

RELEASE DATE FEB. 24, 2011 | SHEET 1 OF 1

MATERIAL	BY	DATE
FINISH (UNLESS NOTED ON DWG.)	DRAWN	JPZ
WEIGHT	CHECKED	
	APP'D	
	SCALE	NONE
ALL DIMENSIONS IN MM		

REGISTERED DESIGN; PATENTS PENDING